

AEREA SUD di MICHELE BRUCOLI



VIALE TOMMASO COLUMBO, 17 - 70123 BARI

TEL. 080.5342454 - 080.5346061

FAX 080.5342441

CELL. 3920619352

SITO INTERNET: WWW.AEREA SUD.IT E.MAIL: tina@brucoli.it



DIN EN ISO 9001
Certificato N° 71 100 D 107



PARTITA IVA 04249100720 - CODICE FISCALE BRC MHL 55B07 A662T - C.C.I.A.A. 302819 - ALBO AGENTI 6701

Noleggino Piattaforme Aeree

AEREA SUD di MICHELE BRUCOLI



VIALE TOMMASO COLUMBO, 17 - 70123 BARI
 TEL. 080.5342454 - 080.5346061
 FAX 080.5342441
 CELL. 3920619352
 SITO INTERNET: WWW.AEREA SUD.IT E.MAIL: tina@brucoli.it



SEL 17

17 AJX

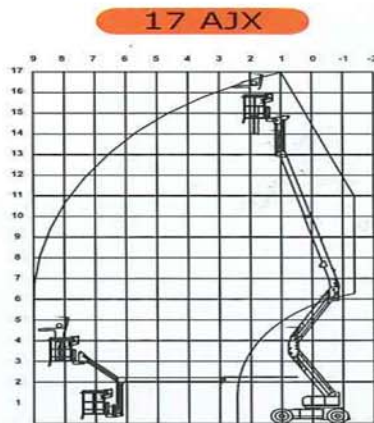

Oscillating axle

The AX range machines have an active oscillating axle hydraulically controlled that re-balance through a level valve in the center of the axle. This ensures all 4 wheels remain on the ground during work on uneven ground.



Max load limiting device

The cage has a mechanical load limiting device to avoid overloading of the cage and increase safety.

Two Inclinometers

We take care to ensure the safety of our platforms. Two inclinometers control that the platform does not exceed the 5° gradeability in any part of its structure.



TECHNICAL FEATURES

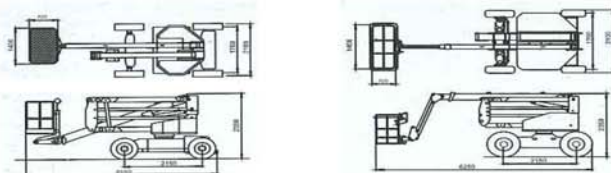

TECHNICAL FEATURES 17 AJX

Working height	16,8
Height to the basket floor	14,8
Max. side outreach	9,5
Max. capacity in the cage	200
Jib length	1,5
Max. length	6,2
Max. width	2,1
Stowed machine height	2,4
Wheelbase	2,1
Ground clearance	0,3
Cage dimensions	1,4 X 0,8
Travel speed km/h	0-5
External steering radius	2,8
Turret rotation	360°
Platform rotation	90°+90°
Engine	Hatz 24 kW
Controls	Proportional
Gradeability %	30/60
Tyres	Filled
Hydraulic tank (lt)	70
Fuel tank (lt)	50
Total weight	8000
Active oscillating axle	yes
Max. inclination	5°
Electric circuit	24 V
Starting battery	2 x 80 AH
Max wind speed Km/h	45

STANDARD EQUIPMENT 17 AJX

Load limiting device	yes
Inclinometer	double
Emergency descent	yes
Travel sign	yes
Hour-meter	yes
Battery charging indicator	no
Lifting and traction hooks	yes
Platform colour	yes
2 sets of operation manuals	yes
CE Certificate	yes

OPTIONALS 17 AJX

Engine	3L40 36 Kw HATZ diesel engine	yes
Special equipment	4 WD	yes
	4 WS	yes
Platform accessories	Traction battery bio-energy + pump	yes
	Automatic battery charger	yes
	2 x 220V 2,7 Kw motor pump	yes
	3 x 380V 5,0 Kw motor pump	yes
	24 V emergency motor pump	yes
	Sand anti-penetration kit	yes
	Oscillating axle	std
	Working light	yes
	1000 V insulation working platform	yes
	Road lighting	yes
Tyres	Radio intercom system	yes
	Fixed intercom	yes
	Anti-collision kit	yes
	220 V power to the basket	yes
	Air-water outlet in the cage	yes
	Platform 1,6m + load limiting device	yes
	Platform 1,8m + load limiting device	yes
	Platform 2,0m + load limiting device	yes
	No marking tracks	yes
	Tracked chassis	yes
Painting	Anti-acid painting	n.a.
	Special marine paint	yes

PARTITA IVA 04249100720 - CODICE FISCALE BRC MHL 55B07 A662T - C.C.I.A.A. 302819 - ALBO AGENTI 6701

Noleggio Piattaforme Aeree